

LTR.	REVISIONS	DATE	INT.
A	3842-003 WAS 3842	5-19-05	BRH
B	ADDED OPTIONAL CONSTRUCTION NOTE	4-04-06	BRH
C	REMOVED OPTIONAL CONSTRUCTION NOTE	10-20-15	RAS
D	PN 329NDV** CHANGED TO 329N0N**	6-23-16	MDL
E	3842-006 WAS 3842-003	3-24-17	JMM
F	UPDATED AND ADDED DIMENSIONS FOR MOUNTING	7-31-17	RAS
G	REPLACED CURRENT LIMITS WITH TEMPERATURE LIMIT	10-12-18	RAS

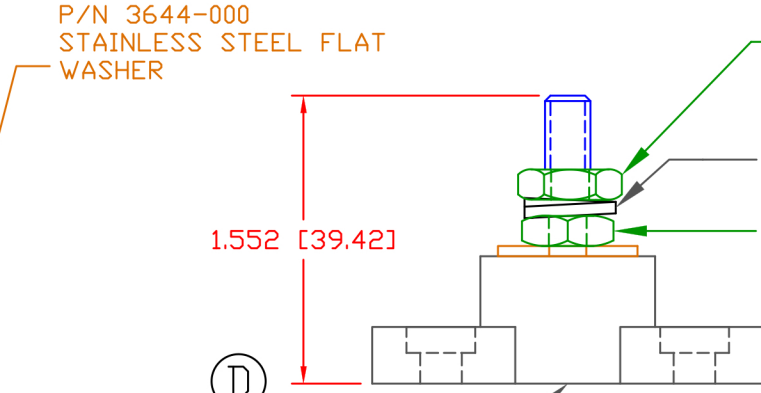
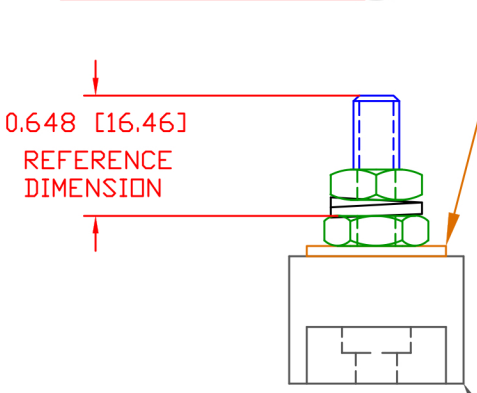
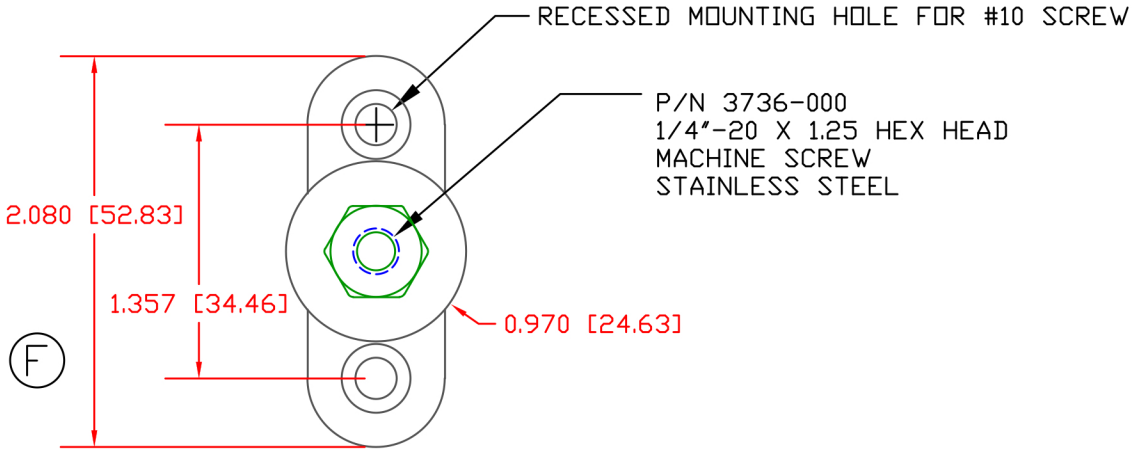

P/N 3644-000
STAINLESS STEEL FLAT
WASHER

P/N 3842-006 1/4"-20 STAINLESS
STEEL HEAVY HEX JAM NUT
(2) REQ'D

P/N 3637-000 STAINLESS STEEL
LOCK WASHER

P/N 3842-006 BOTTOM NUT FACTORY
INSTALLED TO 72 IN./LBS.
(DO NOT REMOVE)

329N0N14
CAVITY PLUG

327N2N14
MOLDED HOUSING

SCALE FACTOR : NONE
ALL DIMENSIONS GIVEN AS: in [mm]
TOLERANCES UNLESS OTHERWISE SPECIFIED :
MOLDED PARTS: ±.030" [±0.8mm]
HARDWARE ITEMS: ±.010" [±0.25mm]

MATERIAL:
VENDOR PART NO:
SPECIFIC GRAVITY:
MELTING TEMP:
U.L. RATING:

GLASS FILLED NYLON
HYLON N2015 HL BK
1.23
515 F [268 C]
UL 94 HB

(G) OVERALL ASSEMBLY TEMPERATURE NOT TO EXCEED 140 DEGREES F
(60 DEGREES C)
MAXIMUM RECOMMENDED TORQUE: 60 IN./LBS.

DO NOT SCALE



REF:	DATE: 09APR03	DRN BY: BRH CHK'D BY: BRH	WEIGHT:
TITLE: 1/4" SMALL JUNCTION STUD			SCALE:
MATERIAL:		PART NO. 670153	
COLOR: BLACK	DRG CLASS REV G		