

| LTR. | REVISIONS | DATE | INT. |
|------|--|----------|------|
| A | 3842-003 WAS 3842 | 5-19-05 | BRH |
| B | ADDED OPTIONAL CONSTRUCTION NOTE | 4-04-06 | BRH |
| C | REMOVED OPTIONAL CONSTRUCTION NOTE | 10-20-15 | RAS |
| D | PN 329NDV** CHANGED TO 329N0N** | 6-23-16 | MDL |
| E | 3842-006 WAS 3842-003 | 3-24-17 | JMM |
| F | UPDATED AND ADDED DIMENSIONS FOR MOUNTING | 7-31-17 | RAS |
| G | REPLACED CURRENT LIMITS WITH TEMPERATURE LIMIT | 10-12-18 | RAS |

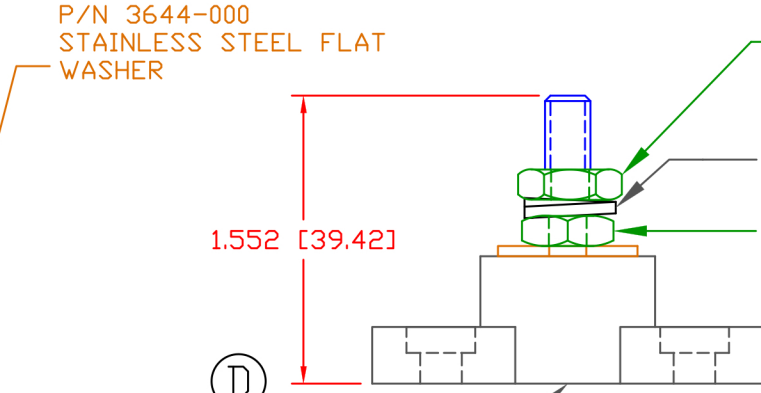
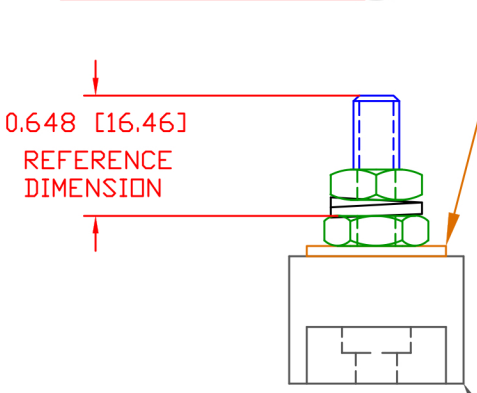
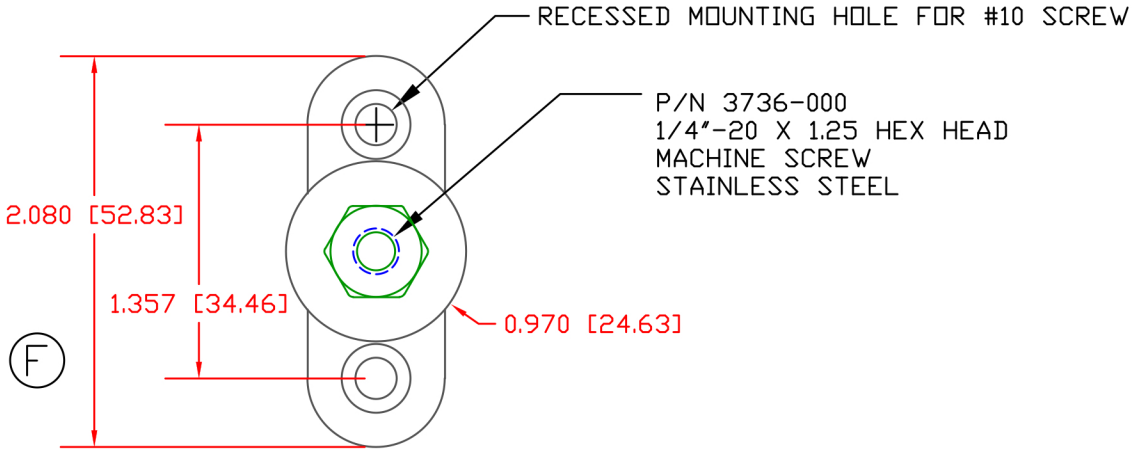

327N2N02
MOLDED HOUSING

MATERIAL:
VENDOR PART NO:
SPECIFIC GRAVITY:
MELTING TEMP:
U.L. RATING:

GLASS FILLED NYLON
HYLON N2015 HL NAT
1.23
515 F [268 C]
UL 94 HB

(G) OVERALL ASSEMBLY TEMPERATURE NOT TO EXCEED 140 DEGREES F
(60 DEGREES C)
MAXIMUM RECOMMENDED TORQUE: 60 IN./LBS.

SCALE FACTOR : NONE
ALL DIMENSIONS GIVEN AS: in [mm]
TOLERANCES UNLESS OTHERWISE SPECIFIED :
MOLDED PARTS: ±.030" [±0.8mm]
HARDWARE ITEMS: ±.010" [±0.25mm]

DO NOT SCALE



| | | | |
|------------------------------------|------------------|------------------------------|---------|
| REF: | DATE: 09APR03 | DRN BY: BRH CHK'D BY: BRH | WEIGHT: |
| TITLE: 1/4" SMALL JUNCTION STUD | | | SCALE: |
| MATERIAL: | | PART NO. 670152 | |
| COLOR: RED | DRG CLASS: REV G | | |